

Tous droits strictement réservés. Reproduction ou communication o des tiers interdite sous quelque forme que ce soit sans autorisation écrite du propriétaire. Property of F C I b.v. © F C I b.v.

Reproduction or issue to third parties in any form, whatever is not permitted without written authority from the proprietor. Property of F C I b.v. © F C I b.v.

PRODUCT NUMBER	COLOR
85812-101LF	GREEN
85812-101NLF	NATURAL

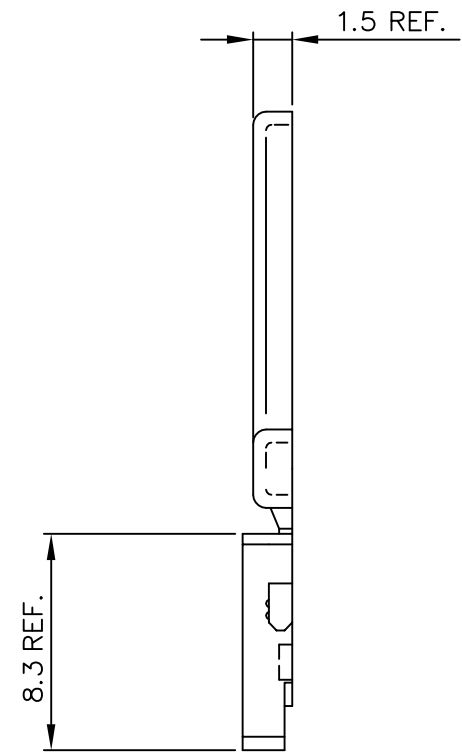
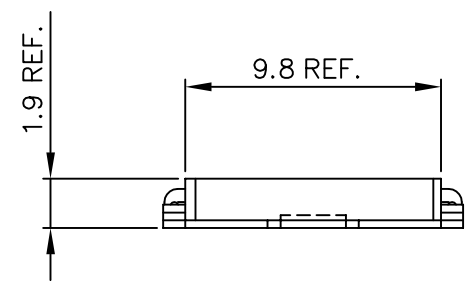
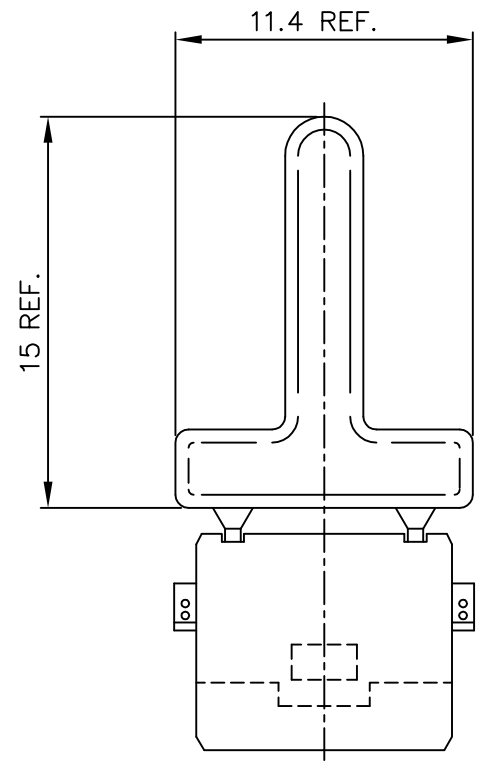

- NOTES:
- MAT'L: LIQUID CRYSTAL POLYMER. FLAME RETARDANT ACC. UL 94-VO, 30% GLASS FILLED, COLOR-GREEN.
 - THIS PRODUCT WITH "LF" SUFFIX MEETS EUROPEAN UNION DIRECTIVES AND OTHER COUNTRY REGULATIONS AS DESCRIBED IN GS -22-008.
 - THE PRODUCT IS NOT INTENDED TO BE EXPOSED TO A MANUFACTURING SOLDER PROCESS.

mat'l. code		tolerances unless otherwise specified			CUSTOMER COPY	ELECTRONICS www.fciconnect.com	
SEE NOTE 1							
ltr	ecn no	dr	date			projection	title
A	H40101	VWO	940211	linear			FEMALE KEY FULL, EXTENDED
B	H40259	VWO	940420				
C	H40487	DDB	940729	angles			
D	H40545	VWO	940831	dr	H v Woensel	940211	product family
E	H50073	RVI	950201	eng	H v Woensel	940211	NATURAL (tm)
F	T03-0279	MW	030709	chr	H Cooijmans	940411	code
G	bc05-0392	CLu	051017	app	H Cooijmans	940411	sheet
sheet	revision	G					213
index	sheet	1					1 of 1